

# Two Channel Dimmer Controller ( 0–10V )

Master of light brightness and color temperature

# Catalog

## Two Channel Dimmer Controller (0–10V)

- Product
- Configurations
- Highlights
- Applications
- Installation Steps
- Setup Steps
- Caution



# Product

## Two Channel Dimmer Controller (0–10V)

After brightness, people are more and more aware of the influence of color temperature in indoor lighting.

Results show that when the temperature is at 3300K, the light is mainly red, which gives a warm and relaxed feeling. At 3300-6000K, red, green and blue light accounted. When the temperature is above 6000K, the blue light will occupy the room. In this environment, you will feel serious, cool and low.

As a result, there are many lamps and lanterns in the market. Among these lamps, there are three main types of dimmer controllers: SCR, 0-10V, PWM

Two Channel Dimmer Controller can control the brightness and color temperature of lights based on 0-10V.





# Configurations

## Two Channel Dimmer Controller (0–10V)

- Size: 40\*150.5\*28mm
- Input: 100-250V AC
- Output: 0-10V
- Distance: 100m
- Protocol: CoSS
- Static power consumption: 1W
- Working temperature: -5~45°C
- Working Humidity: 5~90%

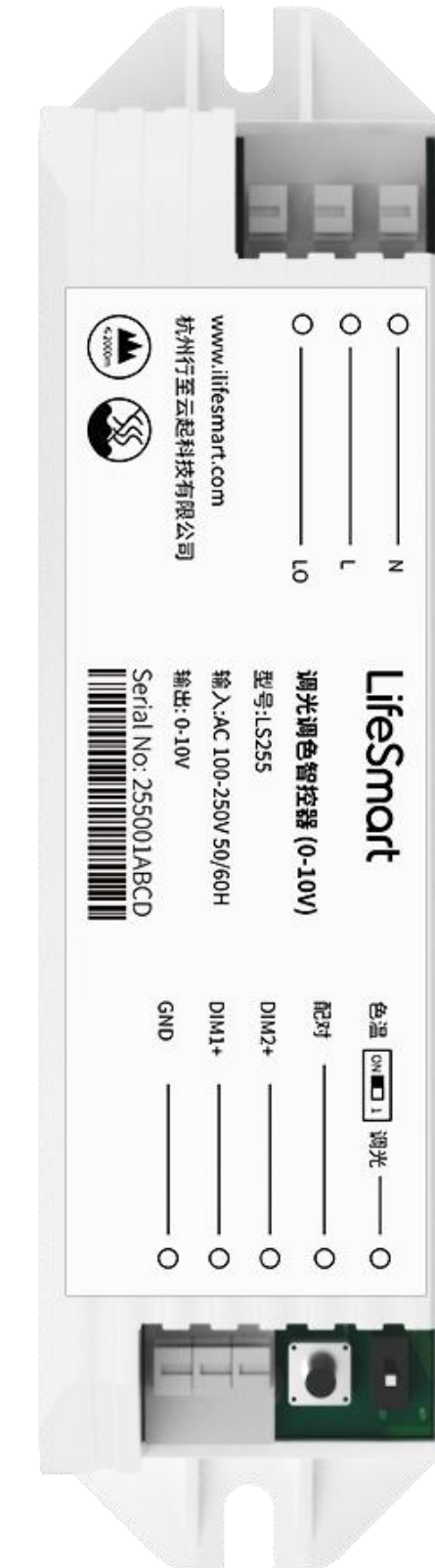

# Highlights

## Two Channel Dimmer Controller (0–10V)



Stable and  
reliable protocol  
of CoSS



Adjust both brightness  
and temperature

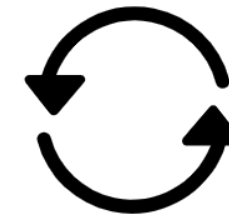

Soft transition  
of lights



Timing change of  
temperature and  
brightness



Connected to most standard  
0-10V dimming downlights,  
spotlights, light strip

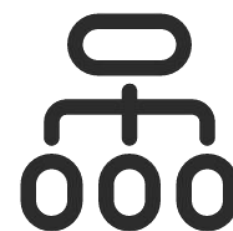

Can controll up  
to 50 dimming  
lights at the  
same time



Multi control  
LifeSmart App、Nature Mini、  
Voice speakers



Linkage with other  
lifeSmart smart devices



# Applications

## Two Channel Dimmer Controller (0–10V)

- Family environment: bedroom, study, living room, dining room, family cinema, children's room, etc.
- Office environment
- Business environment: shop, cinema, E-sports hall.







# Installation Steps

## Two Channel Dimmer Controller (0–10V)

When the driving has no “light mixing” function, turn the dial switch to “1”, and connect as shown in the right figure:

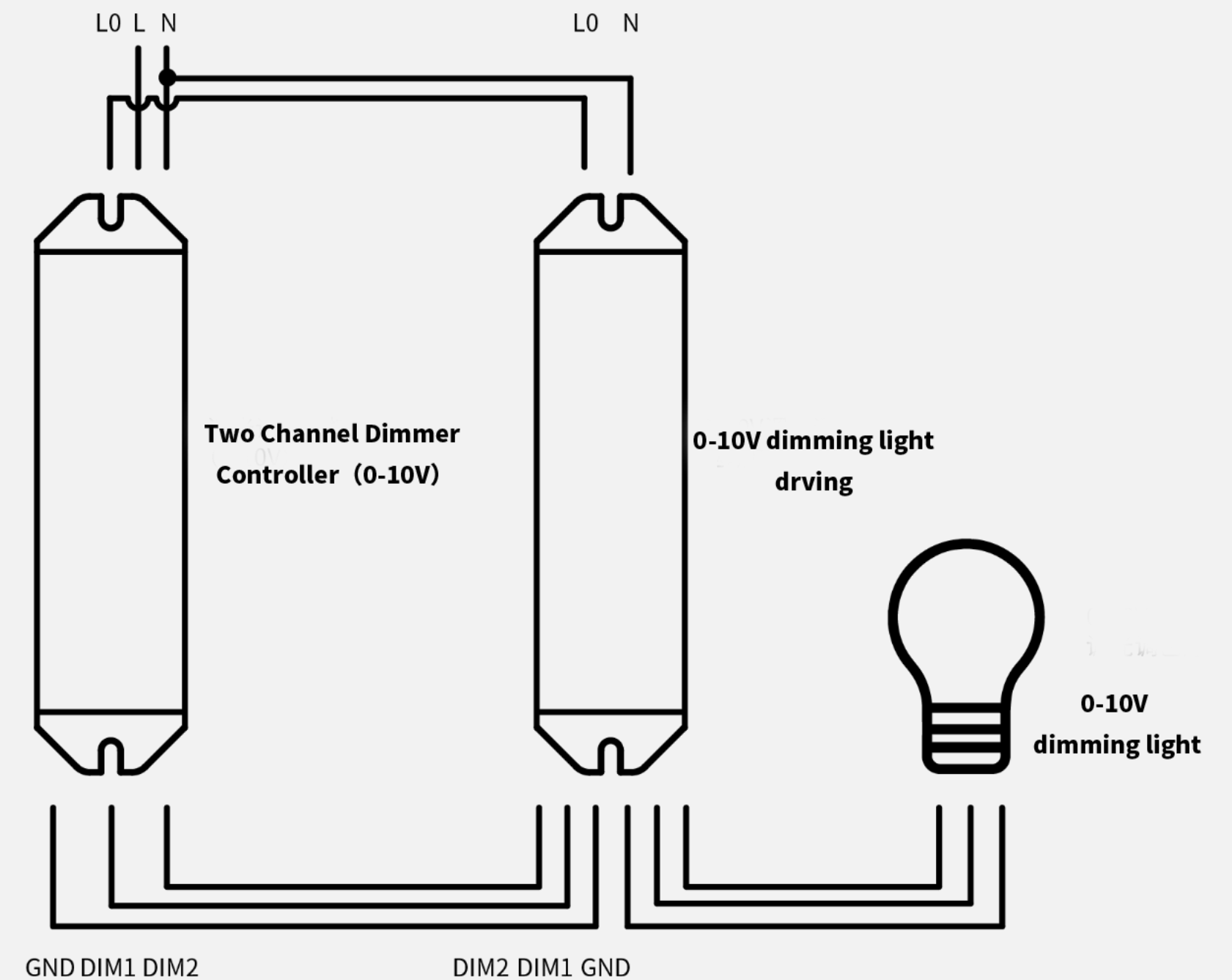



## Two Channel Dimmer Controller (0-10V)

When the driving has “light mixing” function, turn the dial switch to “ON”, and connect as shown in the right figure:

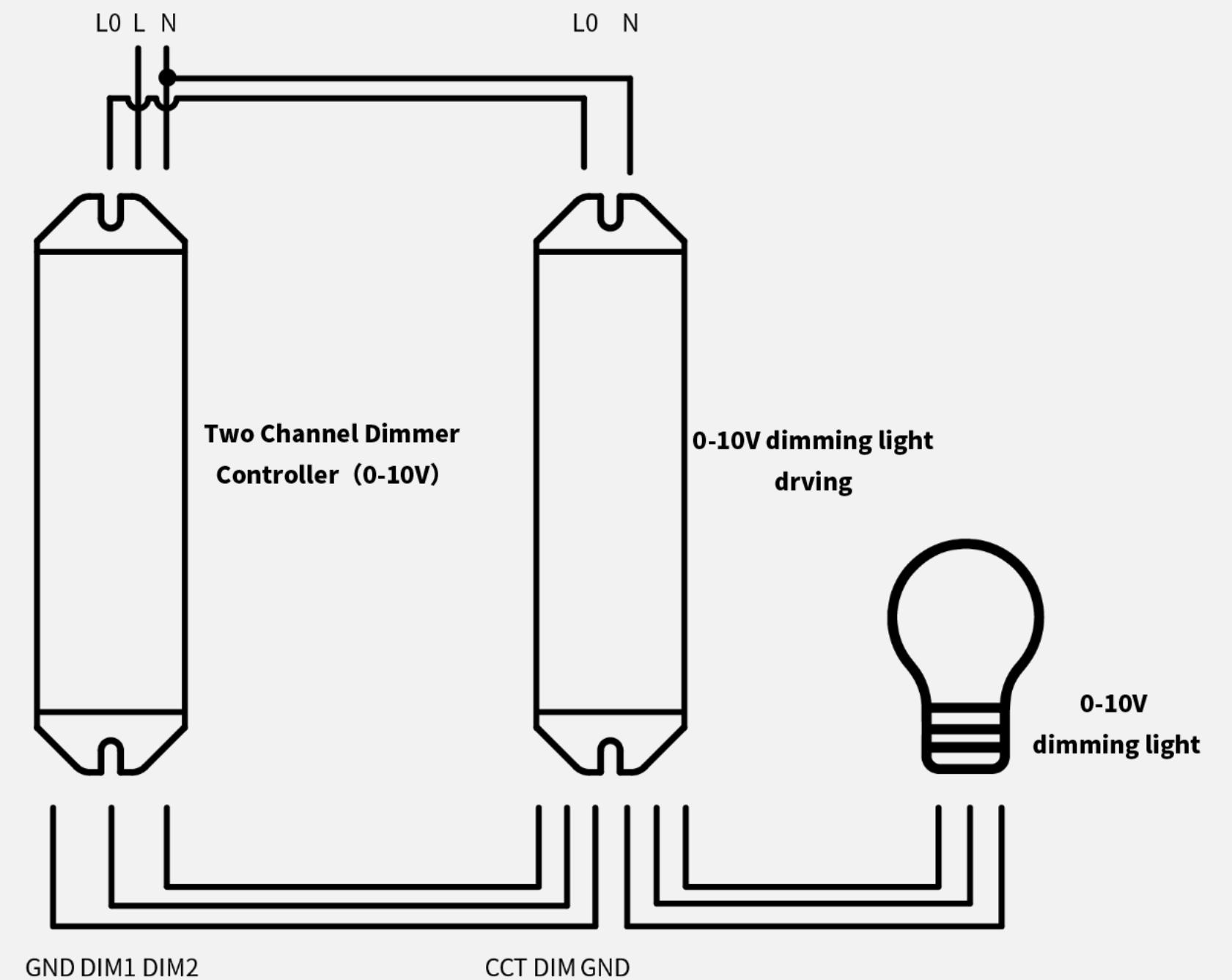

# Setup Steps

## Two Channel Dimmer Controller (0–10V)

- Prepare a LifeSmart Smart Station and add it to the LifeSmart App account.
- Power on the equipment after connecting.
- Open LifeSmart App, select "Add Device", find "Two Channel Dimmer Controller (0-10V)" in the list of new devices.
- Complete the pairing according to the app prompts.

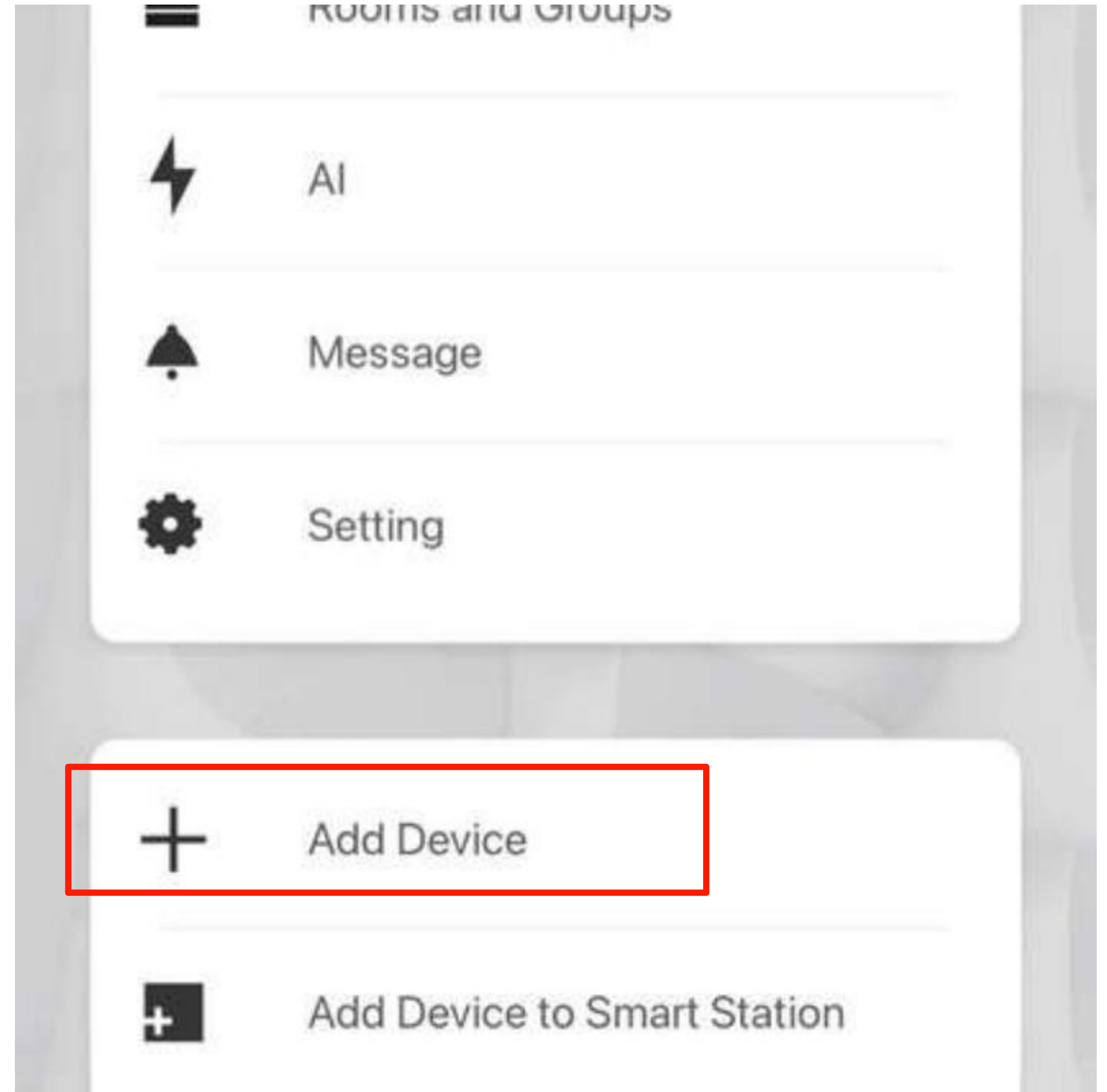



# Setup Steps

## Two Channel Dimmer Controller (0–10V)

- Prepare a Natue Mini and change its working mode to “Use As Smart Station”.
- Power on the equipment after connecting.
- Select “Device” in the Nature Mini menu. Click “+”.
- Press and hold the pairing button on the device for 5 seconds. After releasing, the blue light will continue to flash. Click the “Start Pairing” button on Nature Mini to complete the pairing.



# Caution

## Two Channel Dimmer Controller (0–10V)

- Two Channel Dimmer Controller (0-10V) can only connect and control 0-10V dimming system.
- Two Channel Dimmer Controller (0-10V) can control up to 50 dimming lights at the same time, as long as the control current is controlled within 100mA.
- The output line should not exceed 20 meters.
- To a great extent, the effect of dimming is related to the lights and their driving. Therefore, it is recommended to test the dimming effect before putting it into operation.
- In order to ensure the safety, it is necessary to read the instructions of product carefully before installing the equipment, confirm the wiring type and restraint, and determine the operation and connection under the power-off state.