

LifeSmart®

Simply Brilliant



QuickLink Curtain Motor

USER MANUAL

FEATURES

Intelligent curtain motor for every common home

Manual Operation: When powered on, the curtain could be pull by hand with 10cm. Then the curtain open or close automatically

Manual operation without power: Without power, the curtain could be controlled by hand

Obstacle stop function: the motor could stop when it meets obstacle ,in order to protect the system

Intermediate position: motor could have a intermediate position which is between close and open position

Automatical position: motor could remember the close and open position, users do not need to reset.

Multi-control: users can choose different ways to control, such as emitter or switch.

Freely assembling: DIY design and customized tracks.

MOTOR PARAMETER

Motor Type	Rated Torque	Load	Dimension	Nominal Voltage	Nominal Consumption	IP
BCM100D	1.2Nm	≤50Kg	50*50*270mm	AC100-240V 50/60Hz	40W	IP20

TRACK LOAD

Length	3m	4m	5m	6m	7m	8m
Curtain Weight	50kg	50kg	50kg	45kg	45kg	45kg

EXPLODED VIEW

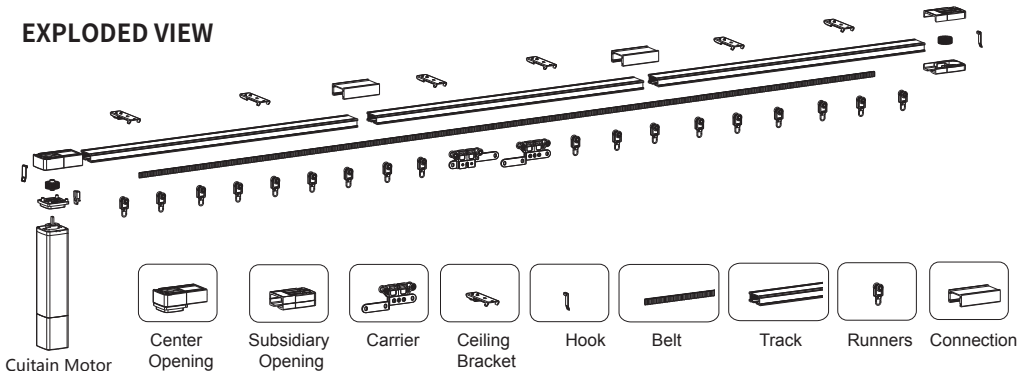

The solutions of intelligent curtain model

	Total length	Length of track (mm)	Track connector (mm)	Length of adjustable track(mm)						Suitable size
				Length of track(mm)			Track connector(mm)			
				1000	200	100	200	100	100	
2	3.2m	2	2	1	2	1	1	1	1	≤3.2m

- Remarks: 1.The tracks with length of 500mm 、 200mm 、 100mm are adjustable tracks, 200mm 、 100mm track connectors are connecting pieces for adjustable track, please take notice notice that the shortest track should be mounted on the head of the curtain tracks (closest position to the wall) .
- 2.Optional accessories:Side mounting bracket, 90 degree angle

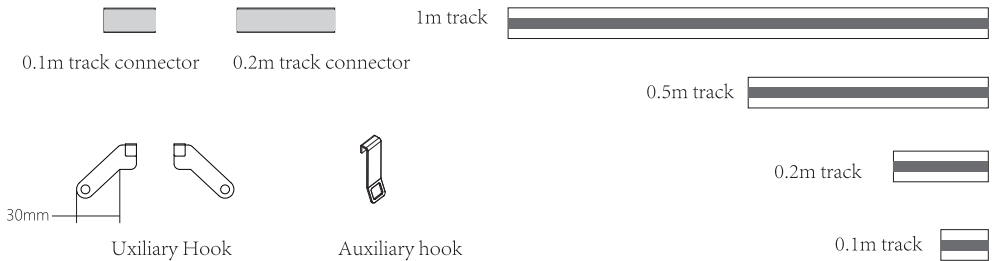

Example:track connect solution

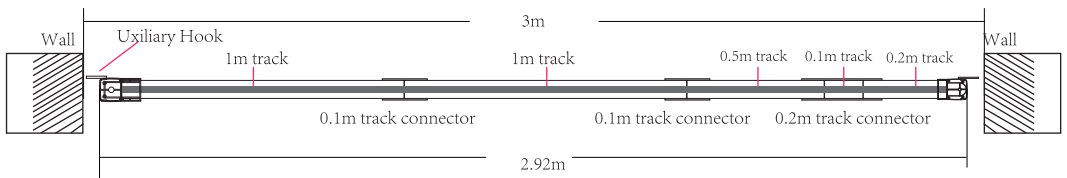

The distance between the track and the wall is at least blank10mm

Pay attention to the solution and the position of 0.1m track connector and 0.2m track connector when you use them
Center opening +Subsidiary opening=0.12m(length)

The distance between the track and the wall is at least blank 10mm

Curtain Track Dimension & Measurement

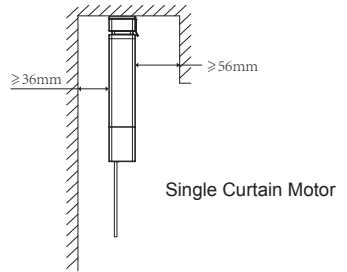
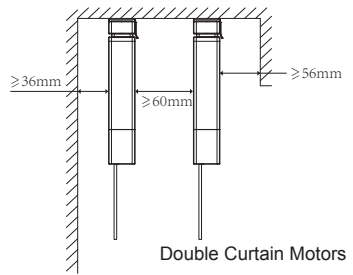
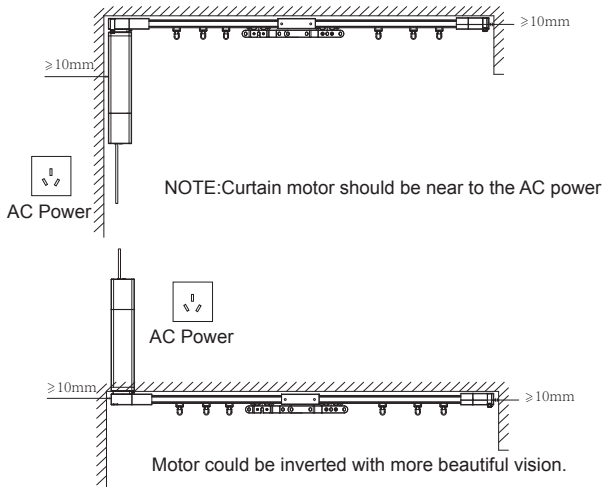

Track Installation Steps

Three sections as an example

- ① Allen wrench
- ② Connections
- ③ Tracks

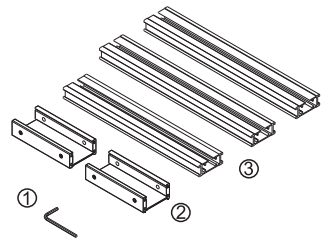

① Put the tracks and connections on flat ground

②

- ① Push the tracks into the connections.
- ② Let the tracks closed in the connection, then tighten the screws through Allen wrench.

NOTE: through tightening the screws, users can adjust the gap of two tracks. No gap, no dislocation.

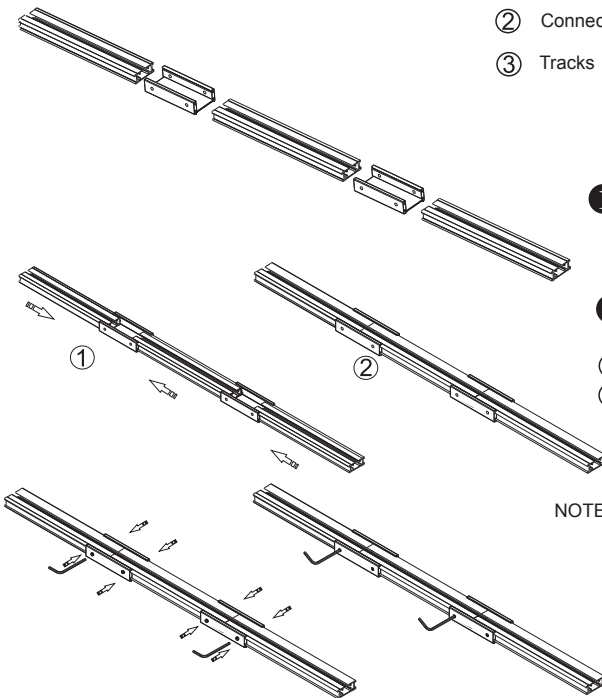
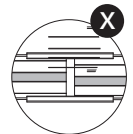

Cutting belt measuring tools instruction manual

Remark: Only applicable double direction opening belt cutting

Double opening direction track needs making two equal length belts in the same way.

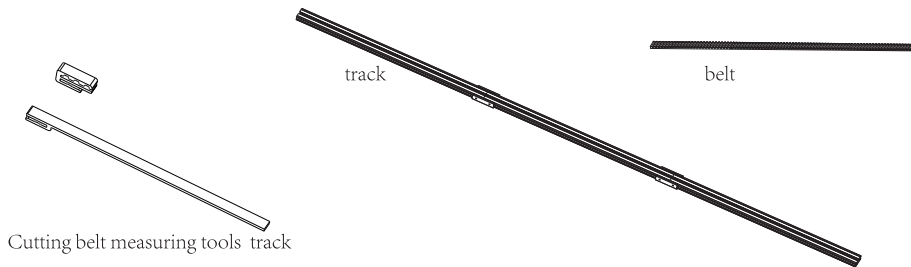

Take the tail set fixed at 1 end

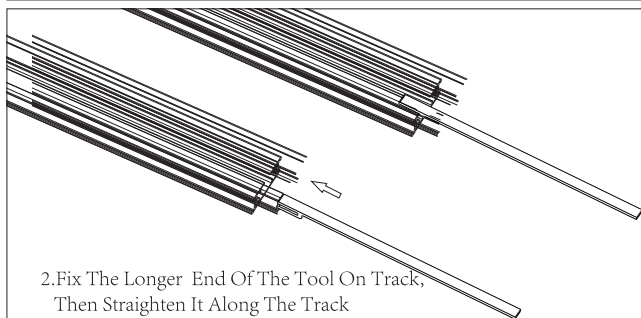
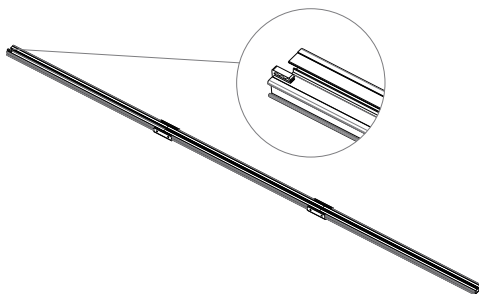
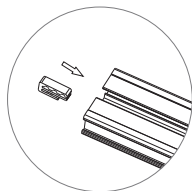

2. Fix The Longer End Of The Tool On Track,
Then Straighten It Along The Track

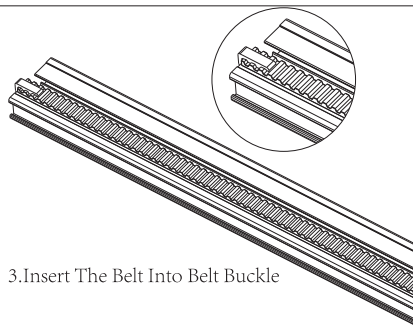

3. Insert The Belt Into Belt Buckle

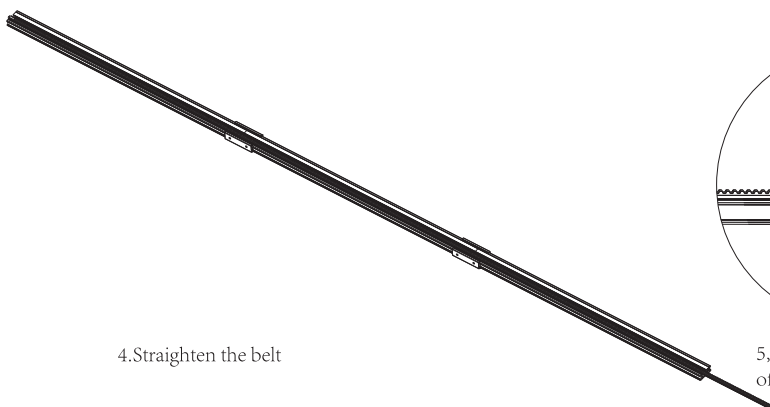

4. Straighten the belt

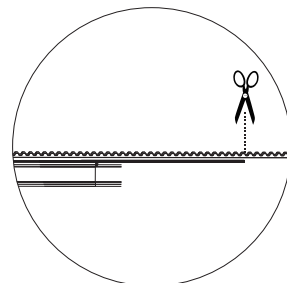

5. Cut the belt in the equal place
of measuring tool

Double-side Open Track Installation Steps

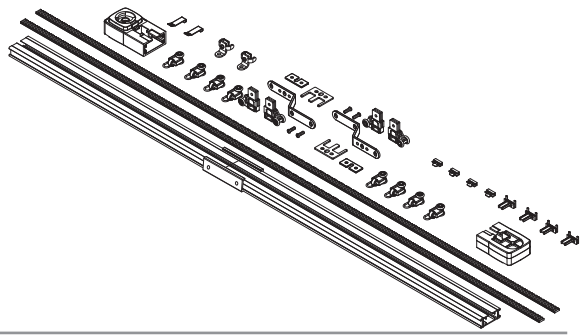

- *Use cutting belt measuring tools to cut belt
- Customer needs 2 belt in same length.
- *Runners: 8pcs per meter; integer forward
- *2pcs hooks
- *2pcs carriers for Double-side Open
- 2 sections track as an sample

1

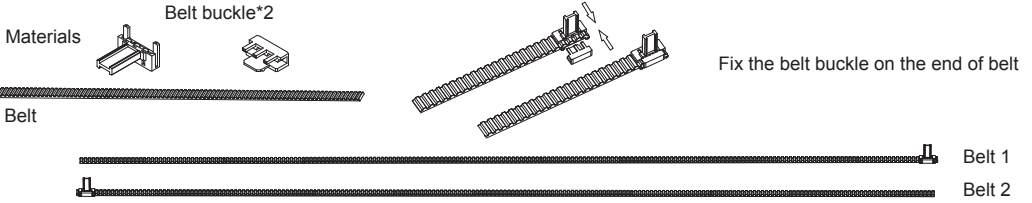

2

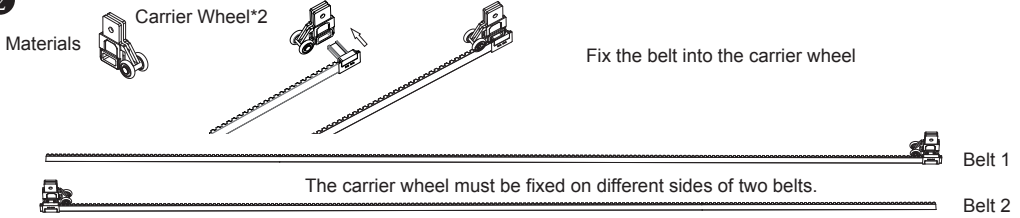

3

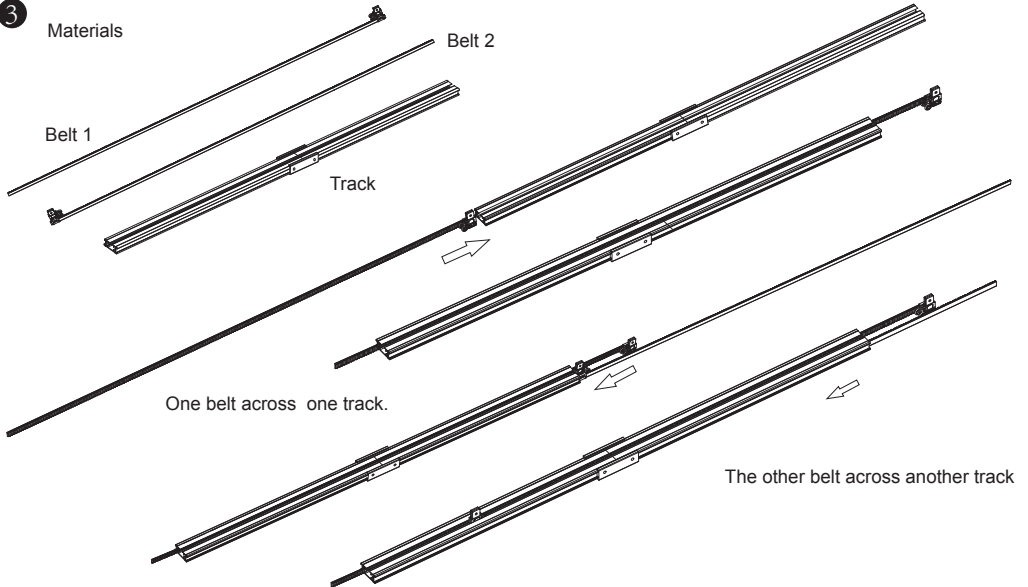

4 Materials



Subsidiary opening
Belt buckle
Carrier wheel

Pull out one belt from the track

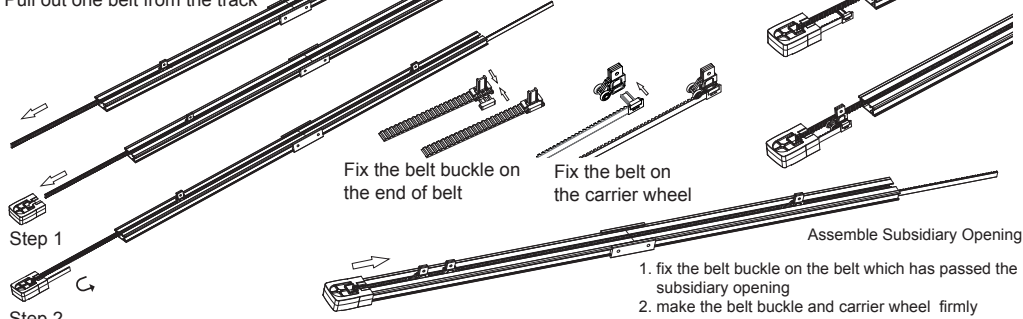

Step 1

Step 2

The belt across the subsidiary opening

Fix the belt buckle on the end of belt

Fix the belt on the carrier wheel

Assemble Subsidiary Opening

1. fix the belt buckle on the belt which has passed the subsidiary opening
2. make the belt buckle and carrier wheel firmly
3. pass the carrier wheel through the track, and push the track in subsidiary opening
4. make the subsidiary opening and track firmly

5

Materials

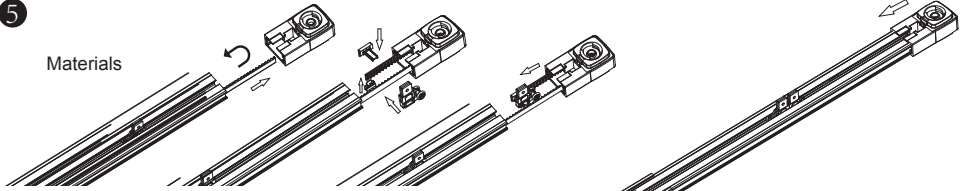

Center opening

Carrier wheel

Belt buckle

Assemble Center Opening

1. the belt across the center opening
2. fix the belt buckle on the end of belt
3. pass the carrier wheel through the track
4. make the center opening and track firmly

6

Carriers*2

Materials

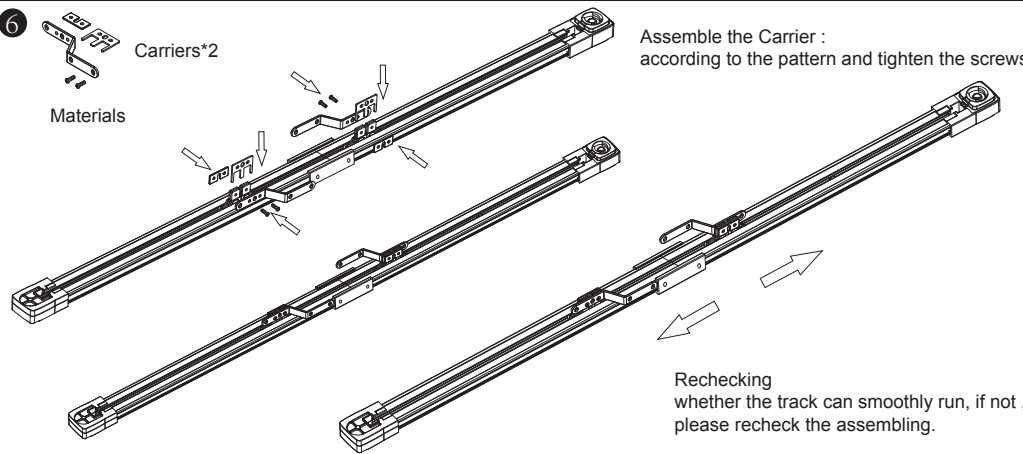

Assemble the Carrier :
according to the pattern and tighten the screws.

Rechecking
whether the track can smoothly run, if not ,
please recheck the assembling.

7

Materials



Runners

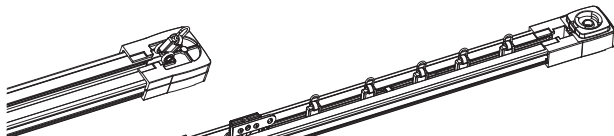

Put the runners into track,
please note 8pcs for every meter.
And the quantity must be same in both side.

8

Materials



Track tensioner

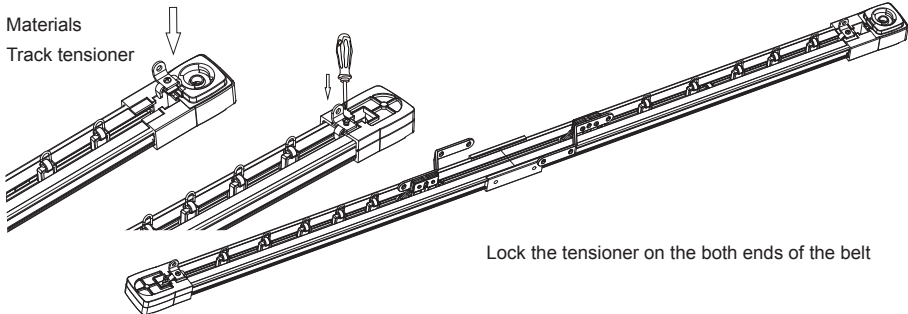

Lock the tensioner on the both ends of the belt

9

Hooks*2

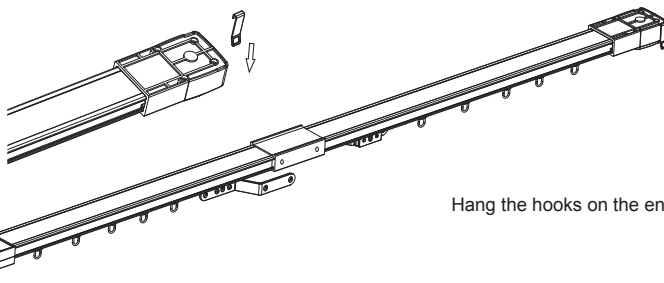

Hang the hooks on the ends of the track

10

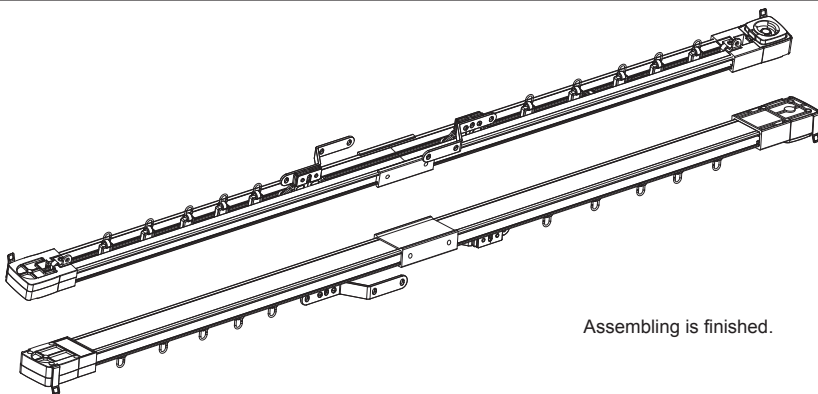

Assembling is finished.

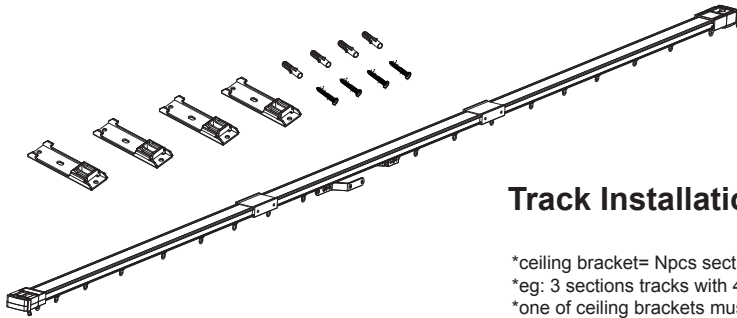

Track Installation Steps

- *ceiling bracket= Npcs section+1pcs
- *eg: 3 sections tracks with 4 ceiling brackets
- *one of ceiling brackets must be near to connection.
- *two of ceiling brackets should be close to both opening.
- 3 sections track as an sample

1 Location of Ceiling bracket

Materials

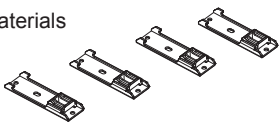

Ceiling bracket*4

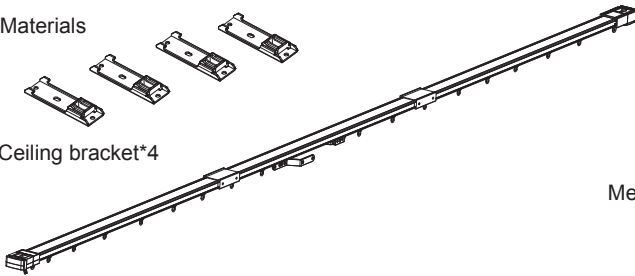

Measuring the distance in advance

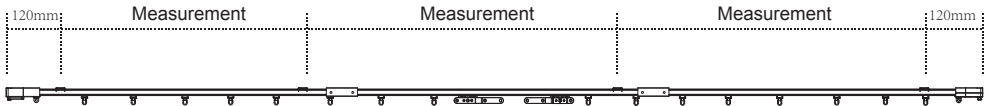

NOTE: One of the ceiling bracket must be near to the connection

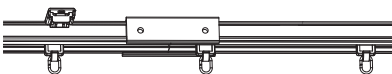

2 Fix the Ceiling bracket

Ceiling bracket*4 & screws

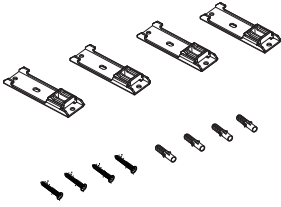

If the wall is concrete, please use the expansion screw

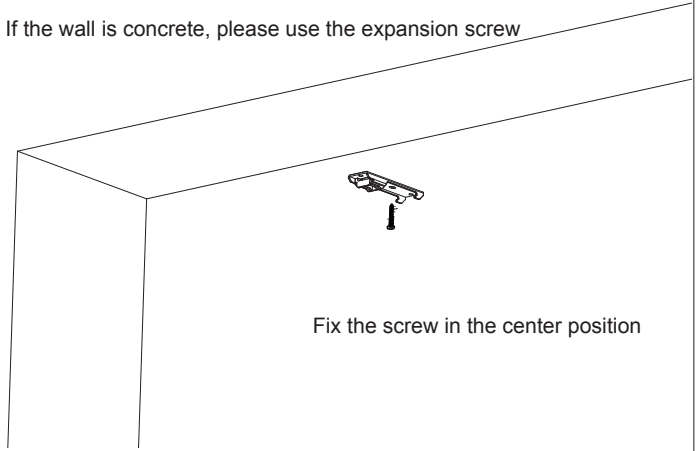

Fix the screw in the center position

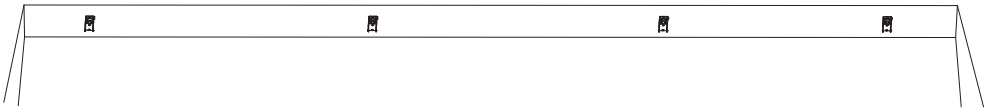

After determine the location, mounting the ceiling bracket

3 Track Installation

Materials

Track*1

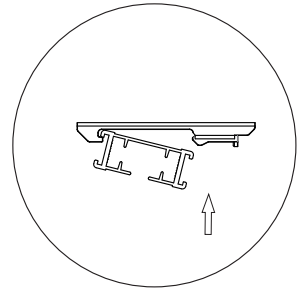
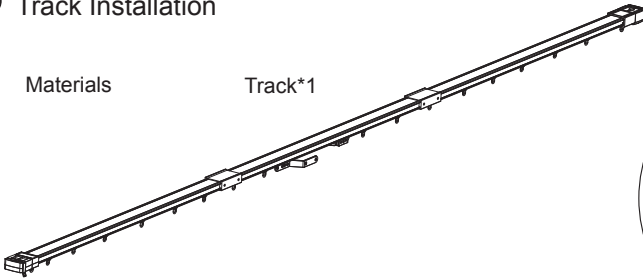

Insert one side of the track, then push and make the track fully go into the ceiling bracket

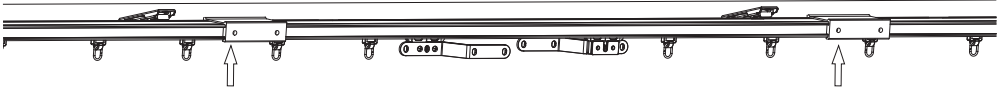

④ TEST

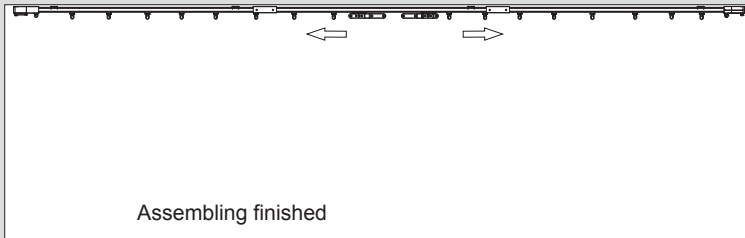

NOTE:

1. recheck the carrier, whether the track can smoothly run, if not ,please recheck the assembling.
2. recheck the connections,keep the connections and track close.
3. the hook should face to the users,not to the wall.

Disassembly of track

Follow the steps

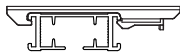

Original state

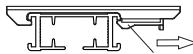

Slip the lock

Ceiling bracket lock

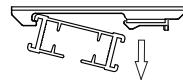

Take off the track

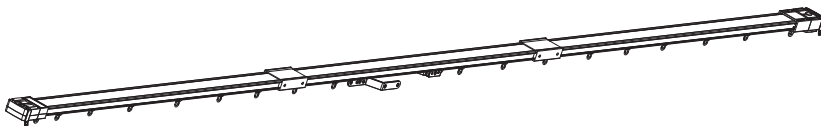

MOTOR

① Materials

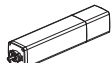

Motor



Track

Shaft & spigot

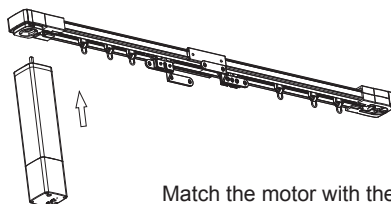
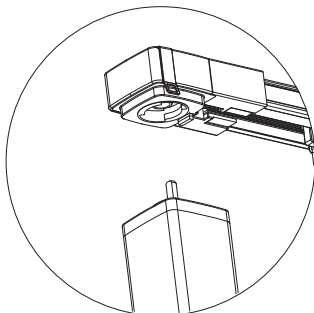
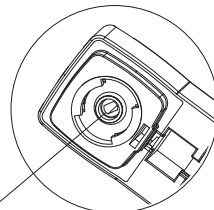

Match the motor with the spigot of the center opening

2

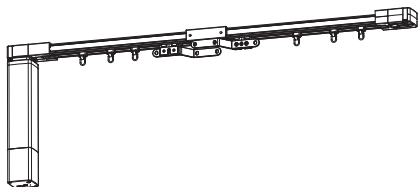

Complete matching

3

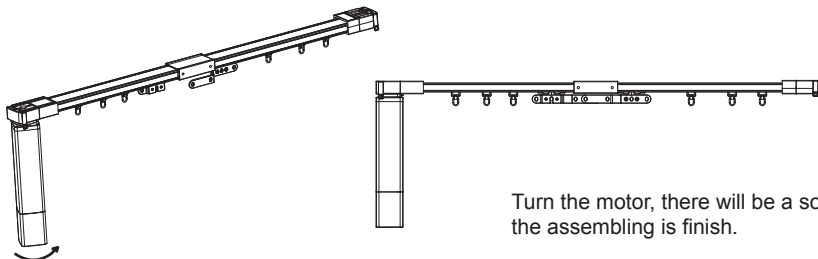

Turn the motor, there will be a sound of lock.
the assembling is finish.

Disassembly of motor

1

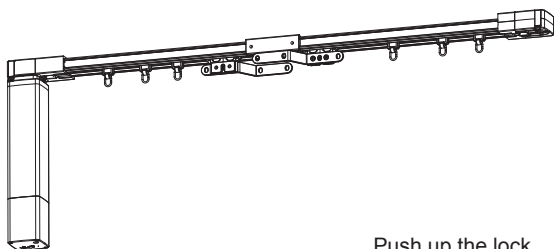

Push up the lock

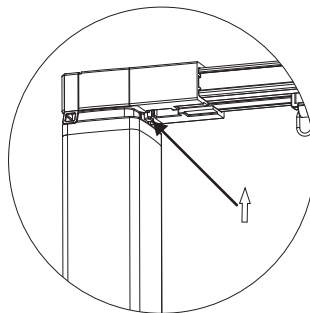

2

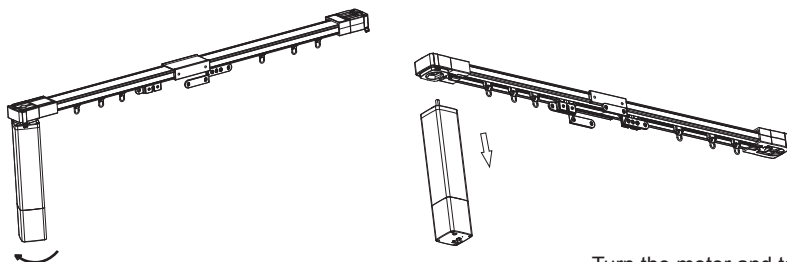

Turn the motor and take it off.

3

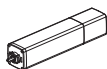

Motor

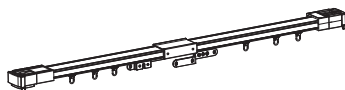

Track

Disassembly is finished.

Emitters

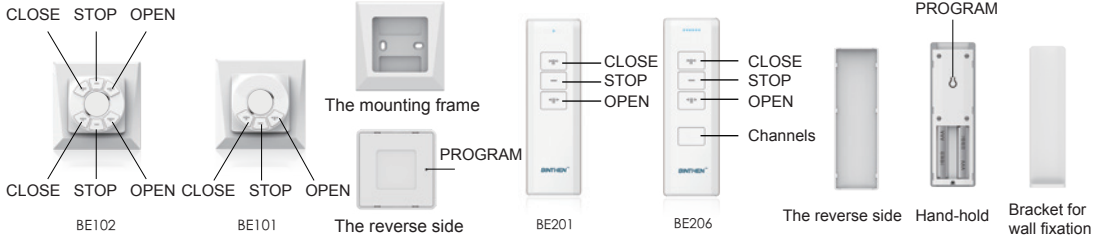

Code Matching

Motor is powered on, the light glitters twice and then extinguishes. Within 10s, the motor is in being matched state. After 10s, the being matched state will be closed automatically. The light will extinguish after 3s.

Motor have 3 methods for matching. Powered on, Short press PROGRAM and Copy.

When the motor is in being matched state, users press the PROGRAM of a totally new emitter, the motor will vibrate once in every direction. Then the code matching of the new emitter is successful.

Method I : Powered On

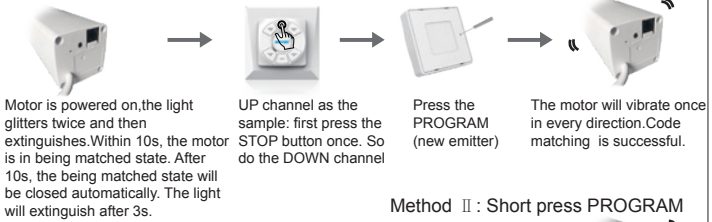

Method II : Short press PROGRAM

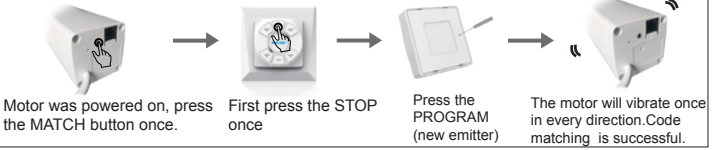

Method II : copy code

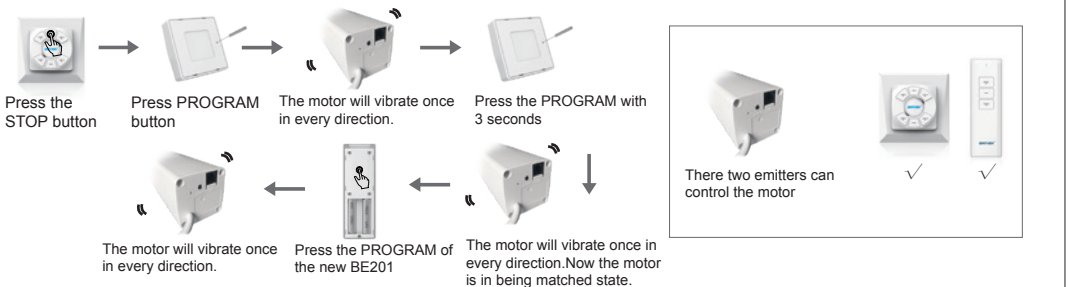

Control the curtain



If the curtain run in a different direction from the order of emitter please set the Direction Change function.

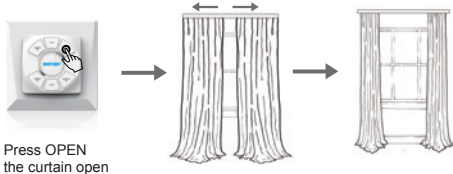

Running

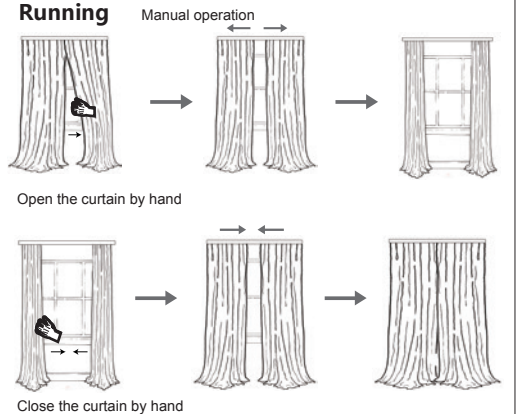

Close the Manual operation Function

Press the STOP & OPEN together till the motor vibrate. The Manual operation function is closed. Users pull the curtain by hand, but motor can not run. Repeat this operation, this function will restart.



Press the STOP & OPEN together

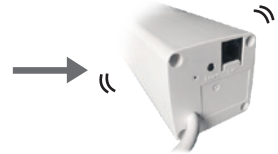

The motor will vibrate once in every direction

Open the Manual operation Function

Press the STOP & OPEN together till the motor vibrate. The Manual operation function is closed. User can pull the curtain by hand, and the motor can run also. Repeat this operation, this function will restart.



Press the STOP & OPEN together



Manual operation Function is opened



Setting the position

When powered on, the curtain will run without any setting. But motor will calculate the length in order to set the open&close position. And new position will replace the old one.



Press STOP button



The motor will vibrate once in every direction



Press OPEN button



The motor vibrate once again.

Open position setting is finished.



The operation is same for setting the position of another direction

If the distance of two positions is less than 30cm, the setting is failed.

Delete the position



Press STOP button



Short press PROGRAM



The motor will vibrate once in every direction



Press STOP button



Press OPEN button



The motor vibrate once again.

2. Long press the MATCH button, the light will glitter 3 times. Then the motor will vibrate once, all the positions are deleted.

The method is same for deleting the position in another direction



Long press MATCH button



The light glitters 3 times



The motor vibrates once again.

Deleting is finished.

3, Repeat the electricity

Intermediate position

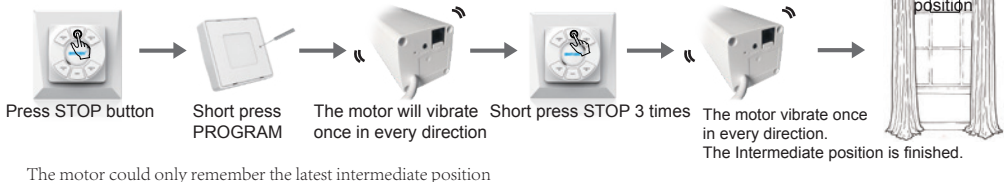

Start the Intermediate position

Long press STOP within 3 seconds, the motor will run to the intermediate position automatically.



The motor will run to the intermediate position automatically

long press STOP within 3 second

Intermediate position

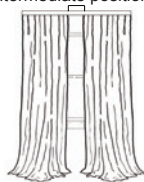

Delete Intermediate position

Method 1: powered on again, all positions are deleted.
Method 2: long press MATCH button

Direction Change

When the motor runs in a different direction which is not the same as the emitter order, the user can operate as follows:

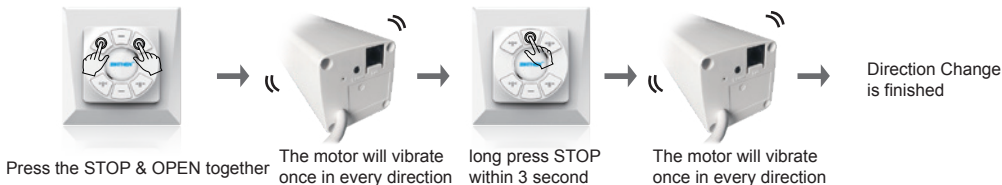

Delete the current emitter



Delete all emitters

Press OPEN and CLOSE together, the motor will vibrate. Then press OPEN 3 times, the motor vibrates again. Delete all emitters.

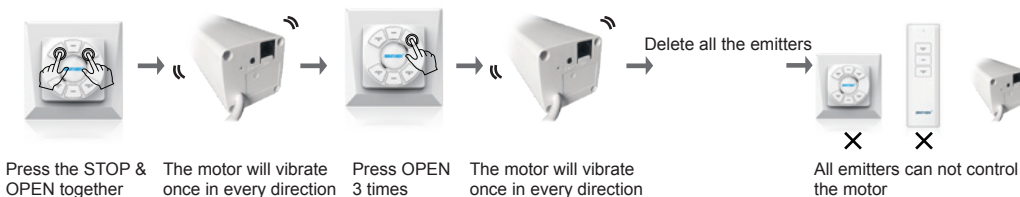

Factory reset After factory reset, the motor will lose all positions. At this time, the first manual function will as the first choice .

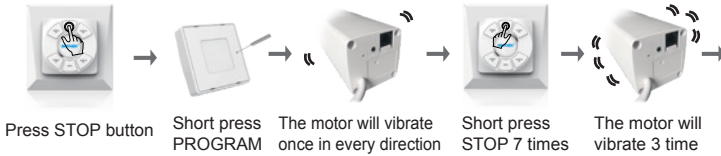

All positions were lost and codes were deleted . At this time, the first manual function will as the first choice .

NOTE:

1. When the motor stop running or finish the setting, the light will keep bright in 3 seconds.
2. after 4mins running , the motor will stop to protect.
3. if the motor is too hot, it will stop to protect. With the temperature dropping, the motor will restart.

RJ11P6C Connection

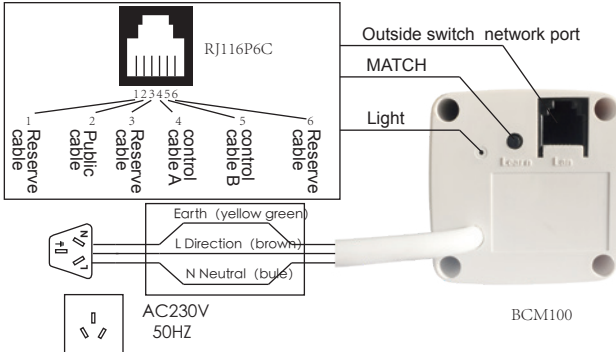

Manual switch (RJ11)
note: manual switch is the default setting.



Press STOP and CLOSE The motor vibrate once in every direction. the manual switch function is started.



Through this operation, motor will change the following manual switches in turn.

First Way

The switch is open when the motor is stop

Close K1 switch, and open K2 , curtains with open,and the motor stops running

Open K1 and K2 switch, the motor will stop running.

Open K1 switch, and close K2, the motor will stop (start) running.

Open K1 and K2 switch, the motor stops running.

Second Way

The switch is open when the motor is stop

Close K1 switch and open K2, the curtains open and the motor stops running.

Open K1 and K2 , the motor keeps running.

Close K1, and open K2 again, the motor stops running.

Open K1 and K2 again, the motor stops running.

Open K1 and close K2, the motor stops running.

Open K1 and K2, the motor keeps running.

Open K1, and close K2 again, the motor stops running.

Open K1 and K2, the motor stops running.

The Third Way

① and ② have the same function, take ① as the example

When the motor stops running and K1 is opening, users close K1, the motor will stop running.

Open K1, motor keeps running. Close K1, motor will stop running.

Open K1, motor stops running. Close K1, the motor stops or starts

Open K1, motor keeps running. Close K1, motor stops. Open K1, motor stops. Steps as a circle

PROBLEM & SOLUTION

- * **Not smoothly running:** adjust the screws of the connections.
- * **Motor stops running:** check the electricity and voltage
- * **Emitter :** check the battery and code matching.
- * **temperature protection:** the AC motor will stop with long-time running. But manual operation function is still available , also motor will remember the position.